

Produits > Instrumentation > Raccords double bague > Doubles bagues Hy-Lok > Union femelle

Té femelle au centre

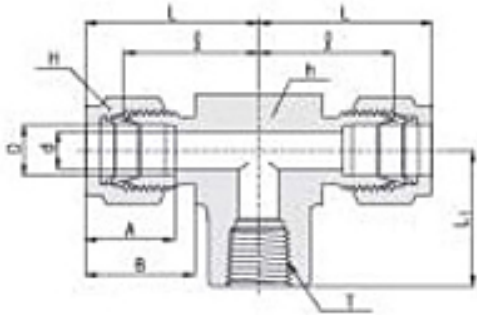

Référence	Tube O.D. (D)	Dimension A	Dimension B	Dimension L	Dimension L ₁	Dimension L ₂	Material	Min. d	T (NPT)	Type
CBTF2-2N-S316	1/8 in 3.17 mm	12.70 mm	15.24 mm	24.38 mm	18.03 mm	19.05 mm	316 Stainless Steel	2.28 mm	1/8 in	Connects Fractional Tube to Male NPT Thread
CBTF4-2N-S316	1/4 in 6.35 mm	15.24 mm	17.78 mm	26.92 mm	19.55 mm	19.05 mm	316 Stainless Steel	4.82 mm	1/8 in	Connects Fractional Tube to Male NPT Thread
CBTF4-4N-S316	1/4 in 6.35 mm	15.24 mm	17.78 mm	29.71 mm	22.35 mm	22.35 mm	316 Stainless Steel	4.82 mm	1/4 in	Connects Fractional Tube to Male NPT Thread
CBTF6-4N-S316	3/8 in 9.52 mm	16.76 mm	19.30 mm	31.24 mm	23.87 mm	22.35 mm	316 Stainless Steel	7.11 mm	1/4 in	Connects Fractional Tube to Male NPT Thread
CBTF8-4N-S316	1/2 in 12.7 mm	22.86 mm	21.84 mm	36.06 mm	25.9 mm	22.35 mm	316 Stainless Steel	10.41 mm	1/4 in	Connects Fractional Tube to Male NPT Thread
CBTF8-6N-S316	1/2 in 12.7 mm	22.86 mm	21.84 mm	36.06 mm	25.9 mm	22.35 mm	316 Stainless Steel	10.41 mm	3/8 in	Connects Fractional Tube to Male NPT Thread
C8TF8-8N-S316	1/2 in 12.7 mm	22.86 mm	21.84 mm	38.86 mm	28.70 mm	28.44 mm	316 Stainless Steel	10.41 mm	1/2 in	Connects Fractional Tube to Male NPT Thread

Référence	Tube O.D. (D)	Dimension A	Dimension B	Dimension L	Dimension I	Dimension L ₁	Material	Min. d	T (NPT)	Type
CBTF10-8N-S316	5/8 in 15.87 mm	24.38 mm	21.84 mm	38.86 mm	28.70 mm	28.44 mm	316 Stainless Steel	12.7 mm	1/2 in	Connects Fractional Tube to Male NPT Thread
CBTF12-12N-S316	3/4 in 19.05 mm	24.38 mm	21.84 mm	44.70 mm	34.54 mm	31.75 mm	316 Stainless Steel	15.74 mm	3/4 in	Connects Fractional Tube to Male NPT Thread
CBTF16-12N-S316	1 in 25.4 mm	31.24 mm	26.41 mm	49.02 mm	36.83 mm	31.75 mm	316 Stainless Steel	22.35 mm	3/4 in	Connects Fractional Tube to Male NPT Thread
CBTF16-16N-S316	1 in 25.4 mm	31.24 mm	26.41 mm	53.59 mm	44.20 mm	38.10 mm	316 Stainless Steel	22.35 mm	1 in	Connects Fractional Tube to Male NPT Thread
CBTF6M-2N-S316	6.0 mm	15.3 mm	17.7 mm	27.0 mm	19.6 mm	19.0 mm	316 Stainless Steel	4.8 mm	1/8 in	Connects Metric Tube to Male NPT Thread
CBTF6M-4N-S316	6.0 mm	15.3 mm	17.7 mm	29.8 mm	22.4 mm	22.4 mm	316 Stainless Steel	4.8 mm	1/4 in	Connects Metric Tube to Male NPT Thread
CBTF6M-6N-S316	6.0 mm	15.3 mm	17.7 mm	31.7 mm	24.40 mm	22.4 mm	316 Stainless Steel	4.8 mm	3/8 in	Connects Metric Tube to Male NPT Thread
CBTF6M-8N-S316	6.0 mm	15.3 mm	17.7 mm	34.5 mm	27.2 mm	28.4 mm	316 Stainless Steel	4.8 mm	1/2 in	Connects Metric Tube to Male NPT Thread
CBTF8M-2N-S316	8.0 mm	16.2 mm	18.6 mm	29.9 mm	23.1 mm	19.0 mm	316 Stainless Steel	6.4 mm	1/8 in	Connects Metric Tube to Male NPT Thread
CBTF8M-4N-S316	8.0 mm	16.2 mm	18.6 mm	30.60 mm	23.1 mm	22.4 mm	316 Stainless Steel	6.4 mm	1/4 in	Connects Metric Tube to Male NPT Thread
CBTF8M-6N-S316	8.0 mm	16.2 mm	18.6 mm	32.4 mm	25.2 mm	22.4 mm	316 Stainless Steel	6.4 mm	3/8 in	Connects Metric Tube to Male NPT Thread
CBTF8M-8N-S316	8.0 mm	16.2 mm	18.6 mm	35.2 mm	28.0 mm	28.4 mm	316 Stainless Steel	6.4 mm	1/2 in	Connects Metric Tube to Male NPT Thread
CBTF10M-4N-S316	10.0 mm	17.2 mm	19.5 mm	33.50 mm	25.9 mm	22.4 mm	316 Stainless Steel	7.9 mm	1/4 in	Connects Metric Tube to Male NPT Thread
CBTF10M-6N-S316	10.0 mm	17.2 mm	19.5 mm	33.3 mm	25.9 mm	22.4 mm	316 Stainless Steel	7.9 mm	3/8 in	Connects Metric Tube to Male NPT Thread
CBTF10M-8N-S316	10.0 mm	17.2 mm	19.5 mm	33.6 mm	26.2 mm	22.4 mm	316 Stainless Steel	9.5 mm	1/2 in	Connects Metric Tube to Male NPT Thread
CBTF12M-4N-S316	12.0 mm	22.8 mm	22.0 mm	36.0 mm	25.9 mm	22.4 mm	316 Stainless Steel	9.5 mm	1/4 in	Connects Metric Tube to Male NPT Thread
CBTF12M-6N-S316	12.0 mm	22.8 mm	22.0 mm	36.0 mm	25.9 mm	22.4 mm	316 Stainless Steel	9.5 mm	3/8 in	Connects Metric Tube to Male NPT Thread
CBTF12M-8N-S316	12.0 mm	22.8 mm	22.0 mm	38.8 mm	28.7 mm	28.4 mm	316 Stainless Steel	9.5 mm	1/2 in	Connects Metric Tube to Male NPT Thread
CBTF16M-8N-S316	16.0 mm	24.4 mm	22.0 mm	38.8 mm	28.7 mm	28.7 mm	316 Stainless Steel	12.7 mm	1/2 in	Connects Metric Tube to Male NPT Thread
CBTF2-2N-STEL	1/8 in 3.17 mm	12.70 mm	15.24 mm	24.38 mm	18.03 mm	19.05 mm	Carbon Steel	2.28 mm	1/8 in	Connects Fractional Tube to Male NPT Thread
CBTF4-2N-STEL	1/4 in 6.35 mm	15.24 mm	17.78 mm	26.92 mm	19.55 mm	19.05 mm	Carbon Steel	4.82 mm	1/8 in	Connects Fractional Tube to Male NPT Thread
CBTF4-4N-STEL	1/4 in 6.35 mm	15.24 mm	17.78 mm	29.71 mm	22.35 mm	22.35 mm	Carbon Steel	4.82 mm	1/4 in	Connects Fractional Tube to Male NPT Thread
CBTF6-4N-STEL	3/8 in 9.52 mm	16.76 mm	19.30 mm	31.24 mm	23.87 mm	22.35 mm	Carbon Steel	7.11 mm	1/4 in	Connects Fractional Tube to Male NPT Thread

Référence	Tube O.D. (D)	Dimension A	Dimension B	Dimension L	Dimension I	Dimension L ₁	Material	Min. d	T (NPT)	Type
CBTF8-4N-STEL	1/2 in 12.7 mm	22.86 mm	21.84 mm	36.06 mm	25.9 mm	22.35 mm	Carbon Steel	10.41 mm	1/4 in	Connects Fractional Tube to Male NPT Thread
CBTF8-6N-STEL	1/2 in 12.7 mm	22.86 mm	21.84 mm	36.06 mm	25.9 mm	22.35 mm	Carbon Steel	10.41 mm	3/8 in	Connects Fractional Tube to Male NPT Thread
C8TF8-8N-STEL	1/2 in 12.7 mm	22.86 mm	21.84 mm	38.86 mm	28.7 mm	28.44 mm	Carbon Steel	10.41 mm	1/2 in	Connects Fractional Tube to Male NPT Thread
CBTF10-8N-STEL	5/8 in 15.87 mm	24.38 mm	21.84 mm	38.86 mm	28.7 mm	28.44 mm	Carbon Steel	12.7 mm	1/2 in	Connects Fractional Tube to Male NPT Thread
CBTF12-12N-STEL	3/4 in 19.05 mm	24.38 mm	21.84 mm	44.70 mm	34.54 mm	31.75 mm	Carbon Steel	15.74 mm	3/4 in	Connects Fractional Tube to Male NPT Thread
CBTF16-12N-STEL	1 in 25.4 mm	31.24 mm	26.41 mm	49.02 mm	36.83 mm	31.75 mm	Carbon Steel	22.35 mm	3/4 in	Connects Fractional Tube to Male NPT Thread
CBTF16-16N-STEL	1 in 25.4 mm	31.24 mm	26.41 mm	53.59 mm	44.20 mm	38.10 mm	Carbon Steel	22.35 mm	1 in	Connects Fractional Tube to Male NPT Thread
CBTF6M-2N-STEL	6.0 mm	15.3 mm	17.7 mm	27.0 mm	19.6 mm	19.0 mm	Carbon Steel	4.8 mm	1/8 in	Connects Metric Tube to Male NPT Thread
CBTF6M-4N-STEL	6.0 mm	15.3 mm	17.7 mm	29.8 mm	22.4 mm	22.4 mm	Carbon Steel	4.8 mm	1/4 in	Connects Metric Tube to Male NPT Thread
CBTF6M-6N-STEL	6.0 mm	15.3 mm	17.7 mm	31.7 mm	24.40 mm	22.4 mm	Carbon Steel	4.8 mm	3/8 in	Connects Metric Tube to Male NPT Thread
CBTF6M-8N-STEL	6.0 mm	15.3 mm	17.7 mm	34.5 mm	27.2 mm	28.4 mm	Carbon Steel	4.8 mm	1/2 in	Connects Metric Tube to Male NPT Thread
CBTF8M-2N-STEL	8.0 mm	16.2 mm	18.6 mm	29.9 mm	23.1 mm	19.0 mm	Carbon Steel	6.4 mm	1/8 in	Connects Metric Tube to Male NPT Thread
CBTF8M-4N-STEL	8.0 mm	16.2 mm	18.6 mm	30.60 mm	23.1 mm	22.4 mm	Carbon Steel	6.4 mm	1/4 in	Connects Metric Tube to Male NPT Thread
CBTF8M-6N-STEL	8.0 mm	16.2 mm	18.6 mm	32.4 mm	25.2 mm	22.4 mm	Carbon Steel	6.4 mm	3/8 in	Connects Metric Tube to Male NPT Thread
CBTF8M-8N-STEL	8.0 mm	16.2 mm	18.6 mm	35.2 mm	28.0 mm	28.4 mm	Carbon Steel	6.4 mm	1/2 in	Connects Metric Tube to Male NPT Thread
CBTF10M-4N-STEL	10.0 mm	17.2 mm	19.5 mm	33.50 mm	25.9 mm	22.4 mm	Carbon Steel	7.9 mm	1/4 in	Connects Metric Tube to Male NPT Thread
CBTF10M-6N-STEL	10.0 mm	17.2 mm	19.5 mm	33.3 mm	25.9 mm	22.4 mm	Carbon Steel	7.9 mm	3/8 in	Connects Metric Tube to Male NPT Thread
CBTF10M-8N-STEL	10.0 mm	17.2 mm	19.5 mm	33.6 mm	26.2 mm	22.4 mm	Carbon Steel	9.5 mm	1/2 in	Connects Metric Tube to Male NPT Thread
CBTF12M-4N-STEL	12.0 mm	22.8 mm	22.0 mm	36.0 mm	25.9 mm	22.4 mm	Carbon Steel	9.5 mm	1/4 in	Connects Metric Tube to Male NPT Thread
CBTF12M-6N-STEL	12.0 mm	22.8 mm	22.0 mm	36.0 mm	25.9 mm	22.4 mm	Carbon Steel	9.5 mm	3/8 in	Connects Metric Tube to Male NPT Thread
CBTF12M-8N-STEL	12.0 mm	22.8 mm	22.0 mm	38.8 mm	28.7 mm	28.4 mm	Carbon Steel	9.5 mm	1/2 in	Connects Metric Tube to Male NPT Thread
CBTF16M-8N-STEL	16.0 mm	24.4 mm	22.0 mm	38.8 mm	28.7 mm	28.7 mm	Carbon Steel	12.7 mm	1/2 in	Connects Metric Tube to Male NPT Thread
CBTF2-2N-BRAS	1/8 in 3.17 mm	12.70 mm	15.24 mm	24.38 mm	18.03 mm	19.05 mm	Brass	2.28 mm	1/8 in	Connects Fractional Tube to Male NPT Thread

Référence	Tube O.D. (D)	Dimension A	Dimension B	Dimension L	Dimension I	Dimension L ₁	Material	Min. d	T (NPT)	Type
CBTF4-2N-BRAS	1/4 in 6.35 mm	15.24 mm	17.78 mm	26.92 mm	19.55 mm	19.05 mm	Brass	4.82 mm	1/8 in	Connects Fractional Tube to Male NPT Thread
CBTF4-4N-BRAS	1/4 in 6.35 mm	15.24 mm	17.78 mm	29.71 mm	22.35 mm	22.35 mm	Brass	4.82 mm	1/4 in	Connects Fractional Tube to Male NPT Thread
CBTF6-4N-BRAS	3/8 in 9.52 mm	16.76 mm	19.30 mm	31.24 mm	23.87 mm	22.35 mm	Brass	7.11 mm	1/4 in	Connects Fractional Tube to Male NPT Thread
CBTF8-4N-BRAS	1/2 in 12.7 mm	22.86 mm	21.84 mm	36.06 mm	25.9 mm	22.35 mm	Brass	10.41 mm	1/4 in	Connects Fractional Tube to Male NPT Thread
CBTF8-6N-BRAS	1/2 in 12.7 mm	22.86 mm	21.84 mm	36.06 mm	25.9 mm	22.35 mm	Brass	10.41 mm	3/8 in	Connects Fractional Tube to Male NPT Thread
C8TF8-8N-BRAS	1/2 in 12.7 mm	22.86 mm	21.84 mm	38.86 mm	28.7 mm	28.44 mm	Brass	10.41 mm	1/2 in	Connects Fractional Tube to Male NPT Thread
CBTF10-8N-BRAS	5/8 in 15.87 mm	24.38 mm	21.84 mm	38.86 mm	28.7 mm	28.44 mm	Brass	12.7 mm	1/2 in	Connects Fractional Tube to Male NPT Thread
CBTF12-12N-BRAS	3/4 in 19.05 mm	24.38 mm	21.84 mm	44.70 mm	34.54 mm	31.75 mm	Brass	15.74 mm	3/4 in	Connects Fractional Tube to Male NPT Thread
CBTF16-12N-BRAS	1 in 25.4 mm	31.24 mm	26.41 mm	49.02 mm	36.83 mm	31.75 mm	Brass	22.35 mm	3/4 in	Connects Fractional Tube to Male NPT Thread
CBTF16-16N-BRAS	1 in 25.4 mm	31.24 mm	26.41 mm	53.59 mm	44.20 mm	38.10 mm	Brass	22.35 mm	1 in	Connects Fractional Tube to Male NPT Thread
CBTF6M-2N-BRAS	6.0 mm	15.3 mm	17.7 mm	27.0 mm	19.6 mm	19.0 mm	Brass	4.8 mm	1/8 in	Connects Metric Tube to Male NPT Thread
CBTF6M-4N-BRAS	6.0 mm	15.3 mm	17.7 mm	29.8 mm	22.4 mm	22.4 mm	Brass	4.8 mm	1/4 in	Connects Metric Tube to Male NPT Thread
CBTF6M-6N-BRAS	6.0 mm	15.3 mm	17.7 mm	31.7 mm	24.40 mm	22.4 mm	Brass	4.8 mm	3/8 in	Connects Metric Tube to Male NPT Thread
CBTF6M-8N-BRAS	6.0 mm	15.3 mm	17.7 mm	34.5 mm	27.2 mm	28.4 mm	Brass	4.8 mm	1/2 in	Connects Metric Tube to Male NPT Thread
CBTF8M-2N-BRAS	8.0 mm	16.2 mm	18.6 mm	29.9 mm	23.1 mm	19.0 mm	Brass	6.4 mm	1/8 in	Connects Metric Tube to Male NPT Thread
CBTF8M-4N-BRAS	8.0 mm	16.2 mm	18.6 mm	30.60 mm	23.1 mm	22.4 mm	Brass	6.4 mm	1/4 in	Connects Metric Tube to Male NPT Thread
CBTF8M-6N-BRAS	8.0 mm	16.2 mm	18.6 mm	32.4 mm	25.2 mm	22.4 mm	Brass	6.4 mm	3/8 in	Connects Metric Tube to Male NPT Thread
CBTF8M-8N-BRAS	8.0 mm	16.2 mm	18.6 mm	35.2 mm	28.0 mm	28.4 mm	Brass	6.4 mm	1/2 in	Connects Metric Tube to Male NPT Thread
CBTF10M-4N-BRAS	10.0 mm	17.2 mm	19.5 mm	33.50 mm	25.9 mm	22.4 mm	Brass	7.9 mm	1/4 in	Connects Metric Tube to Male NPT Thread
CBTF10M-6N-BRAS	10.0 mm	17.2 mm	19.5 mm	33.3 mm	25.9 mm	22.4 mm	Brass	7.9 mm	3/8 in	Connects Metric Tube to Male NPT Thread
CBTF10M-8N-BRAS	10.0 mm	17.2 mm	19.5 mm	33.6 mm	26.2 mm	22.4 mm	Brass	9.5 mm	1/2 in	Connects Metric Tube to Male NPT Thread
CBTF12M-4N-BRAS	12.0 mm	22.8 mm	22.0 mm	36.0 mm	25.9 mm	22.4 mm	Brass	9.5 mm	1/4 in	Connects Metric Tube to Male NPT Thread

Référence	Tube O.D. (D)	Dimension A	Dimension B	Dimension L	Dimension I	Dimension L ₁	Material	Min. d	T (NPT)	Type
CBTF12M-6N-BRAS	12.0 mm	22.8 mm	22.0 mm	36.0 mm	25.9 mm	22.4 mm	Brass	9.5 mm	3/8 in	Connects Metric Tube to Male NPT Thread
CBTF12M-8N-BRAS	12.0 mm	22.8 mm	22.0 mm	38.8 mm	28.7 mm	28.4 mm	Brass	9.5 mm	1/2 in	Connects Metric Tube to Male NPT Thread
CBTF16M-8N-BRAS	16.0 mm	24.4 mm	22.0 mm	38.8 mm	28.7 mm	28.7 mm	Brass	12.7 mm	1/2 in	Connects Metric Tube to Male NPT Thread