

Produits > Instrumentation > Raccords double bague > Doubles bagues Hy-Lok > Union Mâle

Té Mâle Inversé

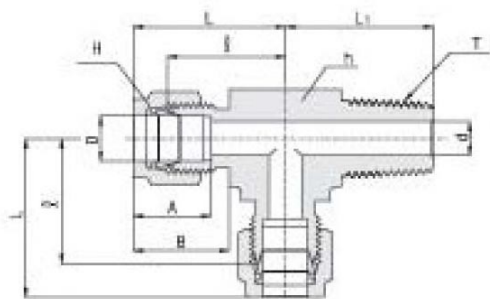

Référence	Tube O.D. (D)	A	B	L	I	L ₁	Material	Min. d	T (NPT)	T [R (PT)]	Type
CRTM2-2N-S316	1/8 in 3.17 mm	12.70 mm	15.24 mm	24.91 mm	17.00 mm	17.8 mm	316 Stainless Steel	2.28 mm	1/8 mm	N/A	Connects Fractional Tube to Female NPT Thread
CRTM2-4N-S316	1/8 in 3.17 mm	12.70 mm	15.24 mm	24.91 mm	18.03 mm	23.36 mm	316 Stainless Steel	2.28 mm	1/4 mm	N/A	Connects Fractional Tube to Female NPT Thread
CRTM3-2N-S316	3/16 in 4.76 mm	13.71 mm	16.00 mm	24.38 mm	17.78 mm	17.78 mm	316 Stainless Steel	3.04 mm	1/8 mm	N/A	Connects Fractional Tube to Female NPT Thread
CRTM4-2N-S316	1/4 in 6.35 mm	15.24 mm	17.78 mm	26.92 mm	19.55 mm	18.79 mm	316 Stainless Steel	4.82 mm	1/8 mm	N/A	Connects Fractional Tube to Female NPT Thread
CRTM4-4N-S316	1/4 in 6.35 mm	15.24 mm	17.78 mm	27.38 mm	19.71 mm	23.87 mm	316 Stainless Steel	4.82 mm	1/4 mm	N/A	Connects Fractional Tube to Female NPT Thread
CRTM5-2N-S316	5/16 in 7.93 mm	16.25 mm	18.54 mm	29.71 mm	22.35 mm	20.82 mm	316 Stainless Steel	4.82 mm	1/8 mm	N/A	Connects Fractional Tube to Female NPT Thread
CRTM6-4N-S316	3/8 in 9.52 mm	16.75 mm	19.30 mm	30.48 mm	23.11 mm	25.40 mm	316 Stainless Steel	7.11 mm	1/4 mm	N/A	Connects Fractional Tube to Female NPT Thread

Référence	Tube O.D. (D)	A	B	L	I	L ₁	Material	Min. d	T (NPT)	T [R (PT)]	Type
CRTM6-6N-S316	3/8 in 9.52 mm	16.76 mm	19.30 mm	31.24 mm	23.87 mm	26.20 mm	316 Stainless Steel	7.11 mm	3/8 mm	N/A	Connects Fractional Tube to Female NPT Thread
CRTM8-6N-S316	1/2 in 12.7 mm	22.86 mm	21.84 mm	36.06 mm	25.9 mm	28.19 mm	316 Stainless Steel	9.65 mm	3/8 mm	N/A	Connects Fractional Tube to Female NPT Thread
CRTM8-8N-S316	1/2 in 12.7 mm	22.86 mm	21.84 mm	36.06 mm	25.9 mm	33.02 mm	316 Stainless Steel	10.41 mm	1/2 mm	N/A	Connects Fractional Tube to Female NPT Thread
CRTM10-8N-S316	5/8 in 15.87 mm	24.38 mm	21.84 mm	38.10 mm	27.94 mm	35.05 mm	316 Stainless Steel	11.93 mm	1/2 mm	N/A	Connects Fractional Tube to Female NPT Thread
CRTM12-12N-S316	3/4 in 19.05 mm	24.38 mm	21.84 mm	38.35 mm	28.19 mm	36.83 mm	316 Stainless Steel	15.74 mm	3/4 mm	N/A	Connects Fractional Tube to Female NPT Thread
CRTM3M-2R-S316	3 mm	12.9 mm	15.3 mm	23.6 mm	17.00 mm	17.8 mm	316 Stainless Steel	2.4 mm	N/A	1/8 mm	Connects Metric Tube to Female ISO Tapered Thread
CRTM3M-4R-S316	3 mm	12.9 mm	15.3 mm	24.6 mm	18.0 mm	23.4 mm	316 Stainless Steel	2.4 mm	N/A	1/4 mm	Connects Metric Tube to Female ISO Tapered Thread
CRTM4M-2R-S316	4 mm	13.7 mm	16.1 mm	25.4 mm	18.8 mm	18.8 mm	316 Stainless Steel	2.4 mm	N/A	1/8 mm	Connects Metric Tube to Female ISO Tapered Thread
CRTM6M-2R-S316	6.0 mm	15.3 mm	17.7 mm	27.0 mm	19.6 mm	18.8 mm	316 Stainless Steel	4.8 mm	N/A	1/8 mm	Connects Metric Tube to Female ISO Tapered Thread
CRTM6M-4R-S316	6.0 mm	15.3 mm	17.7 mm	27.0 mm	19.6 mm	23.4 mm	316 Stainless Steel	4.8 mm	N/A	1/4 mm	Connects Metric Tube to Female ISO Tapered Thread
CRTM8M-2R-S316	8.0 mm	16.2 mm	18.6 mm	28.8 mm	21.3 mm	19.8 mm	316 Stainless Steel	4.8 mm	N/A	1/8 mm	Connects Metric Tube to Female ISO Tapered Thread
CRTM8M-4R-S316	8.0 mm	16.2 mm	18.6 mm	28.8 mm	21.3 mm	24.4 mm	316 Stainless Steel	6.4 mm	N/A	1/4 mm	Connects Metric Tube to Female ISO Tapered Thread
CRTM10M-4R-S316	10.0 mm	17.2 mm	19.5 mm	31.50 mm	23.9 mm	28.2 mm	316 Stainless Steel	7.1 mm	N/A	1/4 mm	Connects Metric Tube to Female ISO Tapered Thread
CRTM10M-6R-S316	10.0 mm	17.2 mm	19.5 mm	31.50 mm	23.9 mm	28.2 mm	316 Stainless Steel	7.9 mm	N/A	3/8 mm	Connects Metric Tube to Female ISO Tapered Thread
CRTM12M-4R-S316	12.0 mm	22.8 mm	22.0 mm	36.0 mm	25.9 mm	28.2 mm	316 Stainless Steel	7.1 mm	N/A	1/4 mm	Connects Metric Tube to Female ISO Tapered Thread
CRTM12M-6R-S316	12.0 mm	22.8 mm	22.0 mm	36.0 mm	25.9 mm	28.2 mm	316 Stainless Steel	9.5 mm	N/A	3/8 mm	Connects Metric Tube to Female ISO Tapered Thread
CRTM12M-8R-S316	12.0 mm	22.8 mm	22.0 mm	36.0 mm	25.9 mm	33.0 mm	316 Stainless Steel	9.5 mm	N/A	1/2 mm	Connects Metric Tube to Female ISO Tapered Thread
CRTM16M-6R-S316	16.0 mm	24.4 mm	22.0 mm	38.0 mm	27.9 mm	30.2 mm	316 Stainless Steel	9.5 mm	N/A	3/8 mm	Connects Metric Tube to Female ISO Tapered Thread
CRTM16M-8R-S316	16.0 mm	24.4 mm	22.0 mm	38.0 mm	27.9 mm	35.1 mm	316 Stainless Steel	11.9 mm	N/A	1/2 mm	Connects Metric Tube to Female ISO Tapered Thread
CRTM20M-12R-S316	20 mm	26.0 mm	22.0 mm	44.6 mm	34.5 mm	41.7 mm	316 Stainless Steel	15.9 mm	N/A	3/4 mm	Connects Metric Tube to Female ISO Tapered Thread
CRTM2-2N-STEL	1/8 in 3.17 mm	12.70 mm	15.24 mm	24.91 mm	17.00 mm	17.8 mm	Carbon Steel	2.28 mm	1/8 mm	N/A	Connects Fractional Tube to Female NPT Thread
CRTM2-4N-STEL	1/8 in 3.17 mm	12.70 mm	15.24 mm	24.91 mm	18.03 mm	23.36 mm	Carbon Steel	2.28 mm	1/4 mm	N/A	Connects Fractional Tube to Female NPT Thread
CRTM3-2N-STEL	3/16 in 4.76 mm	13.71 mm	16.00 mm	24.38 mm	17.78 mm	17.78 mm	Carbon Steel	3.04 mm	1/8 mm	N/A	Connects Fractional Tube to Female NPT Thread

Référence	Tube O.D. (D)	A	B	L	I	L ₁	Material	Min. d	T (NPT)	T [R (PT)]	Type
CRTM4-2N-STEL	1/4 in 6.35 mm	15.24 mm	17.78 mm	26.92 mm	19.55 mm	18.79 mm	Carbon Steel	4.82 mm	1/8 mm	N/A	Connects Fractional Tube to Female NPT Thread
CRTM4-4N-STEL	1/4 in 6.35 mm	15.24 mm	17.78 mm	27.38 mm	19.71 mm	23.87 mm	Carbon Steel	4.82 mm	1/4 mm	N/A	Connects Fractional Tube to Female NPT Thread
CRTM5-2N-STEL	5/16 in 7.93 mm	16.25 mm	18.54 mm	29.71 mm	22.35 mm	20.82 mm	Carbon Steel	4.82 mm	1/8 mm	N/A	Connects Fractional Tube to Female NPT Thread
CRTM6-4N-STEL	3/8 in 9.52 mm	16.75 mm	19.30 mm	30.48 mm	23.11 mm	25.40 mm	Carbon Steel	7.11 mm	1/4 mm	N/A	Connects Fractional Tube to Female NPT Thread
CRTM6-6N-STEL	3/8 in 9.52 mm	16.76 mm	19.30 mm	31.24 mm	23.87 mm	26.20 mm	Carbon Steel	7.11 mm	3/8 mm	N/A	Connects Fractional Tube to Female NPT Thread
CRTM8-6N-STEL	1/2 in 12.7 mm	22.86 mm	21.84 mm	36.06 mm	25.9 mm	28.19 mm	Carbon Steel	9.65 mm	3/8 mm	N/A	Connects Fractional Tube to Female NPT Thread
CRTM8-8N-STEL	1/2 in 12.7 mm	22.86 mm	21.84 mm	36.06 mm	25.9 mm	33.02 mm	Carbon Steel	10.41 mm	1/2 mm	N/A	Connects Fractional Tube to Female NPT Thread
CRTM10-8N-STEL	5/8 in 15.87 mm	24.38 mm	21.84 mm	38.10 mm	27.94 mm	35.05 mm	Carbon Steel	11.93 mm	1/2 mm	N/A	Connects Fractional Tube to Female NPT Thread
CRTM12-12N-STEL	3/4 in 19.05 mm	24.38 mm	21.84 mm	38.35 mm	28.19 mm	36.83 mm	Carbon Steel	15.74 mm	3/4 mm	N/A	Connects Fractional Tube to Female NPT Thread
CRTM3M-2R-STEL	3 mm	12.9 mm	15.3 mm	23.6 mm	17.00 mm	17.8 mm	Carbon Steel	2.4 mm	N/A	1/8 mm	Connects Metric Tube to Female ISO Tapered Thread
CRTM3M-4R-STEL	3 mm	12.9 mm	15.3 mm	24.6 mm	18.0 mm	23.4 mm	Carbon Steel	2.4 mm	N/A	1/4 mm	Connects Metric Tube to Female ISO Tapered Thread
CRTM4M-2R-STEL	4 mm	13.7 mm	16.1 mm	25.4 mm	18.8 mm	18.8 mm	Carbon Steel	2.4 mm	N/A	1/8 mm	Connects Metric Tube to Female ISO Tapered Thread
CRTM6M-2R-STEL	6.0 mm	15.3 mm	17.7 mm	27.0 mm	19.6 mm	18.8 mm	Carbon Steel	4.8 mm	N/A	1/8 mm	Connects Metric Tube to Female ISO Tapered Thread
CRTM6M-4R-STEL	6.0 mm	15.3 mm	17.7 mm	27.0 mm	19.6 mm	23.4 mm	Carbon Steel	4.8 mm	N/A	1/4 mm	Connects Metric Tube to Female ISO Tapered Thread
CRTM8M-2R-STEL	8.0 mm	16.2 mm	18.6 mm	28.8 mm	21.3 mm	19.8 mm	Carbon Steel	4.8 mm	N/A	1/8 mm	Connects Metric Tube to Female ISO Tapered Thread
CRTM8M-4R-STEL	8.0 mm	16.2 mm	18.6 mm	28.8 mm	21.3 mm	24.4 mm	Carbon Steel	6.4 mm	N/A	1/4 mm	Connects Metric Tube to Female ISO Tapered Thread
CRTM10M-4R-STEL	10.0 mm	17.2 mm	19.5 mm	31.50 mm	23.9 mm	28.2 mm	Carbon Steel	7.1 mm	N/A	1/4 mm	Connects Metric Tube to Female ISO Tapered Thread
CRTM10M-6R-STEL	10.0 mm	17.2 mm	19.5 mm	31.50 mm	23.9 mm	28.2 mm	Carbon Steel	7.9 mm	N/A	3/8 mm	Connects Metric Tube to Female ISO Tapered Thread
CRTM12M-4R-STEL	12.0 mm	22.8 mm	22.0 mm	36.0 mm	25.9 mm	28.2 mm	Carbon Steel	7.1 mm	N/A	1/4 mm	Connects Metric Tube to Female ISO Tapered Thread
CRTM12M-6R-STEL	12.0 mm	22.8 mm	22.0 mm	36.0 mm	25.9 mm	28.2 mm	Carbon Steel	9.5 mm	N/A	3/8 mm	Connects Metric Tube to Female ISO Tapered Thread
CRTM12M-8R-STEL	12.0 mm	22.8 mm	22.0 mm	36.0 mm	25.9 mm	33.0 mm	Carbon Steel	9.5 mm	N/A	1/2 mm	Connects Metric Tube to Female ISO Tapered Thread
CRTM16M-6R-STEL	16.0 mm	24.4 mm	22.0 mm	38.0 mm	27.9 mm	30.2 mm	Carbon Steel	9.5 mm	N/A	3/8 mm	Connects Metric Tube to Female ISO Tapered Thread
CRTM16M-8R-STEL	16.0 mm	24.4 mm	22.0 mm	38.0 mm	27.9 mm	35.1 mm	Carbon Steel	11.9 mm	N/A	1/2 mm	Connects Metric Tube to Female ISO Tapered Thread

Référence	Tube O.D. (D)	A	B	L	I	L ₁	Material	Min. d	T (NPT)	T [R (PT)]	Type
CRTM20M-12R-STEL	20 mm	26.0 mm	22.0 mm	44.6 mm	34.5 mm	41.7 mm	Carbon Steel	15.9 mm	N/A	3/4 mm	Connects Metric Tube to Female ISO Tapered Thread
CRTM2-2N-BRAS	1/8 in 3.17 mm	12.70 mm	15.24 mm	24.91 mm	17.00 mm	17.8 mm	Brass	2.28 mm	1/8 mm	N/A	Connects Fractional Tube to Female NPT Thread
CRTM2-4N-BRAS	1/8 in 3.17 mm	12.70 mm	15.24 mm	24.91 mm	18.03 mm	23.36 mm	Brass	2.28 mm	1/4 mm	N/A	Connects Fractional Tube to Female NPT Thread
CRTM3-2N-BRAS	3/16 in 4.76 mm	13.71 mm	16.00 mm	24.38 mm	17.78 mm	17.78 mm	Brass	3.04 mm	1/8 mm	N/A	Connects Fractional Tube to Female NPT Thread
CRTM4-2N-BRAS	1/4 in 6.35 mm	15.24 mm	17.78 mm	26.92 mm	19.55 mm	18.79 mm	Brass	4.82 mm	1/8 mm	N/A	Connects Fractional Tube to Female NPT Thread
CRTM4-4N-BRAS	1/4 in 6.35 mm	15.24 mm	17.78 mm	27.38 mm	19.71 mm	23.87 mm	Brass	4.82 mm	1/4 mm	N/A	Connects Fractional Tube to Female NPT Thread
CRTM5-2N-BRAS	5/16 in 7.93 mm	16.25 mm	18.54 mm	29.71 mm	22.35 mm	20.82 mm	Brass	4.82 mm	1/8 mm	N/A	Connects Fractional Tube to Female NPT Thread
CRTM6-4N-BRAS	3/8 in 9.52 mm	16.75 mm	19.30 mm	30.48 mm	23.11 mm	25.40 mm	Brass	7.11 mm	1/4 mm	N/A	Connects Fractional Tube to Female NPT Thread
CRTM6-6N-BRAS	3/8 in 9.52 mm	16.76 mm	19.30 mm	31.24 mm	23.87 mm	26.20 mm	Brass	7.11 mm	3/8 mm	N/A	Connects Fractional Tube to Female NPT Thread
CRTM8-6N-BRAS	1/2 in 12.7 mm	22.86 mm	21.84 mm	36.06 mm	25.9 mm	28.19 mm	Brass	9.65 mm	3/8 mm	N/A	Connects Fractional Tube to Female NPT Thread
CRTM8-8N-BRAS	1/2 in 12.7 mm	22.86 mm	21.84 mm	36.06 mm	25.9 mm	33.02 mm	Brass	10.41 mm	1/2 mm	N/A	Connects Fractional Tube to Female NPT Thread
CRTM10-8N-BRAS	5/8 in 15.87 mm	24.38 mm	21.84 mm	38.10 mm	27.94 mm	35.05 mm	Brass	11.93 mm	1/2 mm	N/A	Connects Fractional Tube to Female NPT Thread
CRTM12-12N-BRAS	3/4 in 19.05 mm	24.38 mm	21.84 mm	38.35 mm	28.19 mm	36.83 mm	Brass	15.74 mm	3/4 mm	N/A	Connects Fractional Tube to Female NPT Thread
CRTM3M-2R-BRAS	3 mm	12.9 mm	15.3 mm	23.6 mm	17.00 mm	17.8 mm	Brass	2.4 mm	N/A	1/8 mm	Connects Metric Tube to Female ISO Tapered Thread
CRTM3M-4R-BRAS	3 mm	12.9 mm	15.3 mm	24.6 mm	18.0 mm	23.4 mm	Brass	2.4 mm	N/A	1/4 mm	Connects Metric Tube to Female ISO Tapered Thread
CRTM4M-2R-BRAS	4 mm	13.7 mm	16.1 mm	25.4 mm	18.8 mm	18.8 mm	Brass	2.4 mm	N/A	1/8 mm	Connects Metric Tube to Female ISO Tapered Thread
CRTM6M-2R-BRAS	6.0 mm	15.3 mm	17.7 mm	27.0 mm	19.6 mm	18.8 mm	Brass	4.8 mm	N/A	1/8 mm	Connects Metric Tube to Female ISO Tapered Thread
CRTM6M-4R-BRAS	6.0 mm	15.3 mm	17.7 mm	27.0 mm	19.6 mm	23.4 mm	Brass	4.8 mm	N/A	1/4 mm	Connects Metric Tube to Female ISO Tapered Thread
CRTM8M-2R-BRAS	8.0 mm	16.2 mm	18.6 mm	28.8 mm	21.3 mm	19.8 mm	Brass	4.8 mm	N/A	1/8 mm	Connects Metric Tube to Female ISO Tapered Thread
CRTM8M-4R-BRAS	8.0 mm	16.2 mm	18.6 mm	28.8 mm	21.3 mm	24.4 mm	Brass	6.4 mm	N/A	1/4 mm	Connects Metric Tube to Female ISO Tapered Thread
CRTM10M-4R-BRAS	10.0 mm	17.2 mm	19.5 mm	31.50 mm	23.9 mm	28.2 mm	Brass	7.1 mm	N/A	1/4 mm	Connects Metric Tube to Female ISO Tapered Thread

Référence	Tube O.D. (D)	A	B	L	I	L ₁	Material	Min. d	T (NPT)	T [R (PT)]	Type
CRTM10M-6R-BRAS	10.0 mm	17.2 mm	19.5 mm	31.50 mm	23.9 mm	28.2 mm	Brass	7.9 mm	N/A	3/8 mm	Connects Metric Tube to Female ISO Tapered Thread
CRTM12M-4R-BRAS	12.0 mm	22.8 mm	22.0 mm	36.0 mm	25.9 mm	28.2 mm	Brass	7.1 mm	N/A	1/4 mm	Connects Metric Tube to Female ISO Tapered Thread
CRTM12M-6R-BRAS	12.0 mm	22.8 mm	22.0 mm	36.0 mm	25.9 mm	28.2 mm	Brass	9.5 mm	N/A	3/8 mm	Connects Metric Tube to Female ISO Tapered Thread
CRTM12M-8R-BRAS	12.0 mm	22.8 mm	22.0 mm	36.0 mm	25.9 mm	33.0 mm	Brass	9.5 mm	N/A	1/2 mm	Connects Metric Tube to Female ISO Tapered Thread
CRTM16M-6R-BRAS	16.0 mm	24.4 mm	22.0 mm	38.0 mm	27.9 mm	30.2 mm	Brass	9.5 mm	N/A	3/8 mm	Connects Metric Tube to Female ISO Tapered Thread
CRTM16M-8R-BRAS	16.0 mm	24.4 mm	22.0 mm	38.0 mm	27.9 mm	35.1 mm	Brass	11.9 mm	N/A	1/2 mm	Connects Metric Tube to Female ISO Tapered Thread
CRTM20M-12R-BRAS	20 mm	26.0 mm	22.0 mm	44.6 mm	34.5 mm	41.7 mm	Brass	15.9 mm	N/A	3/4 mm	Connects Metric Tube to Female ISO Tapered Thread