

Produits > Hydraulique > Raccords > JIC 37°

## Adapteur mâle orientable

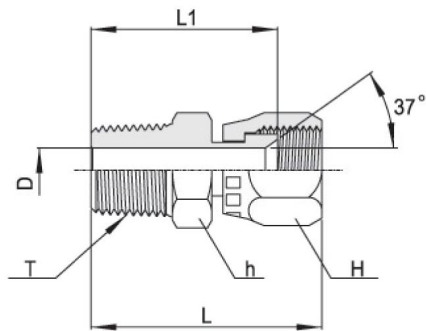

Référence	Dimension D	Dimension H (Hex)	Dimension h (Hex)	Dimension L	Dimension L1	Material	T (NPT)	Tube O.D.	Unified National Fine Thread (U)
FSFMC2T-01N-S316	1.6 mm	11.1 mm	11.1 mm	30.0 mm	22.0 mm	316 Stainless Steel	1/8 in	1/8 in 3 mm	5/16"-24
FSFMC3T-01N-S316	3.2 mm	12.7 mm	11.1 mm	32.0 mm	23.5 mm	316 Stainless Steel	1/8 in	3/16 in 4 mm	3/8"-24
FSFMC4T-01N-S316	4.4 mm	14.2 mm	12.7 mm	34.2 mm	25.5 mm	316 Stainless Steel	1/8 in	1/4 in 6.0 mm	7/16"-20
FSFMC5T-01N-S316	6.0 mm	16.0 mm	14.2 mm	35.0 mm	25.5 mm	316 Stainless Steel	1/8 in	5/16 in 8.0 mm	1/2"-20
FSFMC6T-02N-S316	7.5 mm	17.4 mm	16.0 mm	40.2 mm	30.7 mm	316 Stainless Steel	1/4 in	3/8 in 10.0 mm	9/16"-18
FSFMC8T-03N-S316	9.9 mm	22.2 mm	21.0 mm	42.7 mm	32.0 mm	316 Stainless Steel	3/8 in	1/2 in 12.0 mm	3/4"-16
FSFMC10T-04N-S316	12.3 mm	25.4 mm	23.8 mm	51.30 mm	38.6 mm	316 Stainless Steel	1/2 in	5/8 in 16.0 mm	7/8"-14

Référence	Dimension D	Dimension H (Hex)	Dimension h (Hex)	Dimension L	Dimension L1	Material	T (NPT)	Tube O.D.	Unified National Fine Thread (U)
FSFMC12T-06N-S316	15.5 mm	32.0 mm	29.0 mm	54.5 mm	40.2 mm	316 Stainless Steel	3/4 in	3/4 in 18 mm 20 mm	1 1/16"-12
FSFMC14T-06N-S316	18 mm	35.0 mm	32.0 mm	56.0 mm	41.2 mm	316 Stainless Steel	3/4 in	7/8 in 22 mm	1 3/16"-12
FSFMC16T-08N-S316	21.5 mm	38.0 mm	36.0 mm	63.7 mm	48.6 mm	316 Stainless Steel	1 in	1 in 25 mm	1 5/16"-12
FSFMC20T-10N-S316	37.5 mm	50.8 mm	46.0 mm	68.9 mm	53.0 mm	316 Stainless Steel	1 1/4 in	1 1/4 in 32 mm	1 5/8"-12
FSFMC24T-12N-S316	33.0 mm	57.0 mm	50.0 mm	77.6 mm	59.0 mm	316 Stainless Steel	1 1/2 in	1 1/2 in 38 mm	1 7/8"-12
FSFMC32T-16N-S316	45.0 mm	73 mm	66.7 mm	92.9 mm	69.1 mm	316 Stainless Steel	2 in	2 in 50 mm	2 1/2"-12